

## Building Sketch

Borrower	n/a		
Property Address	1844 E Sheridan St		
City	Phoenix	County Maricopa	State AZ      Zip Code 85006
Lender/Client			

All figures and measurements are approximate.

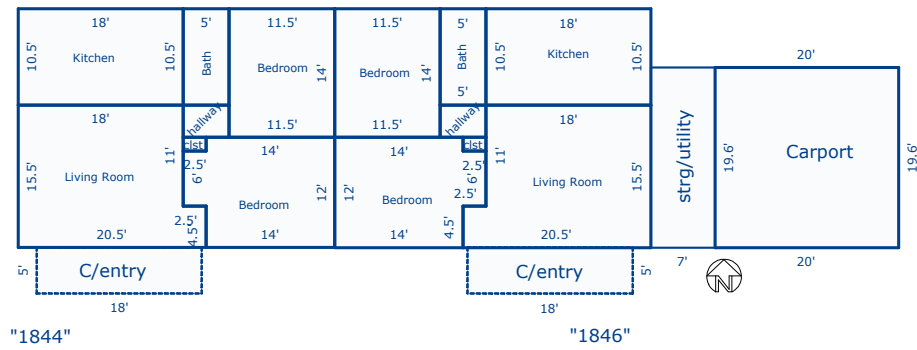

Sketch by Apex Sketch v5 Standard™

Comments:

AREA CALCULATIONS SUMMARY			
Code	Description	Net Size	Net Totals
GLA1	"1844" Living room	290.25	
	"1844" Kitchen	189.00	
	"1844" Bathroom	52.50	
	"1844" Bedroom 1	161.00	
	"1844" Bedroom 2	183.00	
	"1844" Hall closet	3.75	
	"1844" Hallway	17.50	
	"1846" Bedroom 1	161.00	
	"1846" Bedroom 2	183.00	
	"1846" Living Room	290.25	
	"1846" Kitchen	189.00	
	"1846" Bathroom	52.50	
	"1846" Hall closet	3.75	
	"1846" Hallway	17.50	1794.00
GAR	Carport	392.00	392.00
P/P	"1844" Cov'd Entry	90.00	
	"1846" Cov'd Entry	90.00	180.00
OTH	storage/utility	137.20	137.20
Net LIVABLE Area (rounded)			1794

LIVING AREA BREAKDOWN		
	Breakdown	Subtotals
"1844"	Living room	
	4.5 x 20.5	92.25
"1844"	Kitchen	
	11.0 x 18.0	198.00
"1844"	Bathroom	
	10.5 x 18.0	189.00
"1844"	Bathroom	
	5.0 x 10.5	52.50
"1844"	Bedroom 1	
	11.5 x 14.0	161.00
"1844"	Bedroom 2	
	1.5 x 14.0	21.00
"1844"	Kitchen	
	4.5 x 14.0	63.00
"1844"	Hall closet	
	6.0 x 16.5	99.00
"1844"	Hall closet	
	2.5 x 1.5	3.75
"1844"	Hallway	
	3.5 x 5.0	17.50
"1846"	Bedroom 1	
	11.5 x 14.0	161.00
"1846"	Bedroom 2	
	14.0 x 4.5	63.00
"1846"	Kitchen	
	16.5 x 6.0	99.00
"1846"	Kitchen	
	1.5 x 14.0	21.00
"1846"	Living Room	
	20.5 x 4.5	92.25
"1846"	Kitchen	
	11.0 x 18.0	198.00
"1846"	Kitchen	
	10.5 x 18.0	189.00
3		73.75
20 Items	(rounded)	1794

## Building Sketch

Borrower	n/a			
Property Address	1844 E Sheridan St			
City	Phoenix	County Maricopa	State AZ	Zip Code 85006
Lender/Client				

All figures and measurements are approximate.

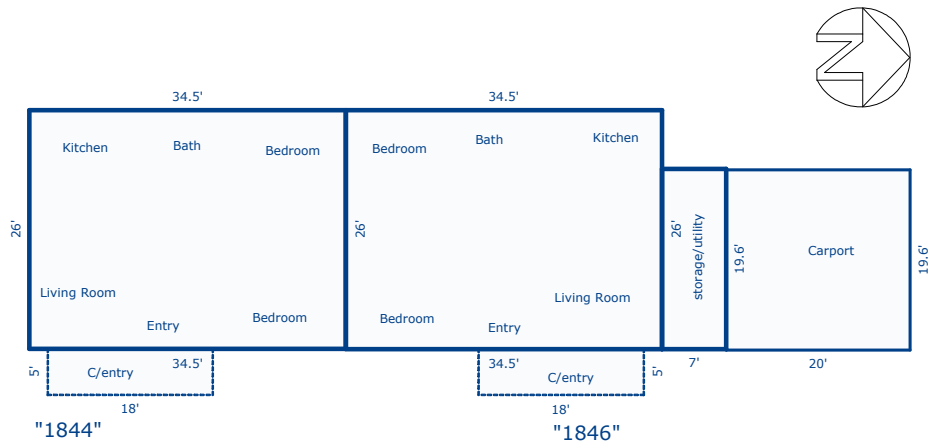

Sketch by Apex Sketch v5 Standard™

Comments:

AREA CALCULATIONS SUMMARY			
Code	Description	Net Size	Net Totals
GBA1	"1844"	897.00	
	"1846"	897.00	
	strg/utility	137.20	1931.20
GAR	Carport	392.00	392.00
P/P	Covered Entry	90.00	
	Covered Entry	90.00	180.00
Net BUILDING Area		(rounded)	1931

BUILDING AREA BREAKDOWN			
Breakdown			Subtotals
"1844"			
	26.0	x 34.5	897.00
"1846"			
	34.5	x 26.0	897.00
strg/utility			
	7.0	x 19.6	137.20
3 Items			(rounded) 1931