

Building Sketch

Borrower	n/a		
Property Address	4841 E Sheridan St		
City	Phoenix	County Maricopa	State AZ Zip Code 85008
Lender/Client	Gerchick Real Estate		

All figures and measurements are approximate.

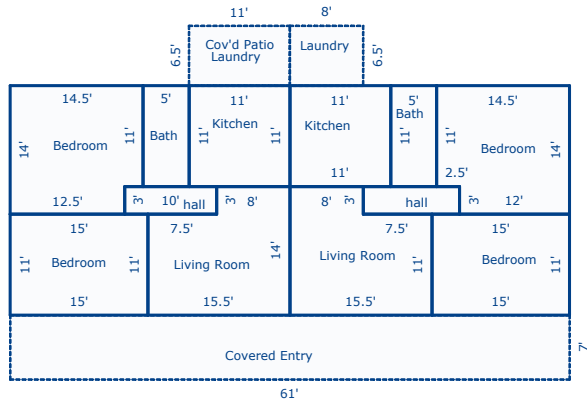

Sketch by Apex Sketch v5 Standard™

Comments:

AREA CALCULATIONS SUMMARY				
Code	Description	Net Size	Net Totals	
GLA1	Unit one bedroom	165.00		
	Unit one living room	194.50		
	Unit one hallway	30.00		
	Unit one kitchen	121.00		
	Unit one bedroom	197.00		
	Unit one bathroom	55.00		
	Unit two living room	194.50		
	Unit two bedroom	165.00		
	Unit two bedroom	195.50		
	Unit two bathroom	55.00		
	Unit two kitchen	121.00		
	Unit two hallway	31.50		
	P/P	Covered Entry	427.00	
		Cov'd Pto/lndry	71.50	
Cov'd Pto/lndry		52.00		
	Net LIVABLE Area	(rounded)	1525	

LIVING AREA BREAKDOWN		
	Breakdown	Subtotals
	Unit one bedroom	
	15.0 x 11.0	165.00
	Unit one living room	
	15.5 x 11.0	170.50
	3.0 x 8.0	24.00
	Unit one hallway	
	3.0 x 10.0	30.00
	Unit one kitchen	
	11.0 x 11.0	121.00
	Unit one bedroom	
	3.0 x 12.5	37.50
	11.0 x 14.5	159.50
	Unit one bathroom	
	5.0 x 11.0	55.00
	Unit two living room	
	15.5 x 11.0	170.50
	3.0 x 8.0	24.00
	Unit two bedroom	
	15.0 x 11.0	165.00
	3.0 x 12.0	36.00
	11.0 x 14.5	159.50
	Unit two bathroom	
	5.0 x 11.0	55.00
	Unit two kitchen	
	11.0 x 11.0	121.00
	Unit two hallway	
	10.5 x 3.0	31.50
	16 Items	(rounded) 1525