

Building Sketch

Borrower	n/a			
Property Address	7602 E Polk St			
City	Scottsdale	County Maricopa	State AZ	Zip Code 85257
Lender/Client	Gerchick Real Estate			

All figures and measurements are approximate.

Total GLA is 4,060+-sf

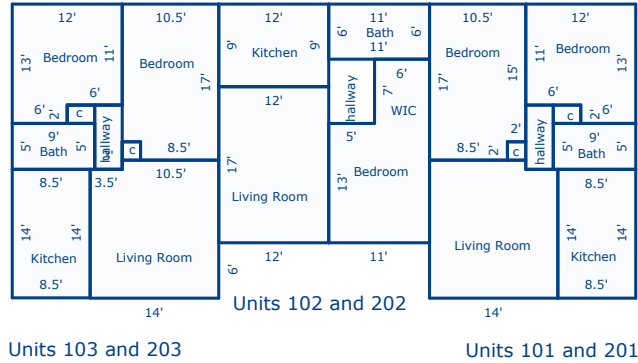

Sketch by Apex Sketch v5 Standard™

Comments:

AREA CALCULATIONS SUMMARY			
Code	Description	Net Size	Net Totals
GLA1	Unit 101/kitchen	119.00	
	Unit 101/bathroom	45.00	
	Unit 101/bedroom	144.00	
	Unit 101/bedroom	174.50	
	Unit 101/closet	6.00	
	Unit 101/closet	4.00	
	Unit 101/hallway	21.00	
	Unit 102/bathroom	66.00	
	Unit 101/living room	206.50	
	Unit 102/bedroom	185.00	
	Unit 102/living room	204.00	
	Unit 102/kitchen	108.00	
	Unit 103/living room	206.50	
	Unit 103/kitchen	119.00	
	Unit 103/bathroom	45.00	
	Unit 103/bedroom	144.00	
	Unit 103/bedroom	201.50	
	Unit 103/closet	4.00	
	Unit 103/closet	6.00	
	Unit 103/hallway	21.00	
	Net LIVABLE Area	(rounded)	2030

LIVING AREA BREAKDOWN			
Breakdown		Subtotals	
Unit 101/kitchen			
14.0 x 8.5		119.00	
Unit 101/bathroom			
5.0 x 9.0		45.00	
Unit 101/bedroom			
2.0 x 6.0		12.00	
11.0 x 12.0		132.00	
2.0 x 8.5		17.00	
15.0 x 10.5		157.50	
Unit 101/closet			
3.0 x 2.0		6.00	
2.0 x 2.0		4.00	
Unit 101/hallway			
3.0 x 7.0		21.00	
Unit 102/bathroom			
6.0 x 11.0		66.00	
Unit 101/living room			
14.0 x 14.0		196.00	
1.0 x 10.5		10.50	
Unit 102/bedroom			
11.0 x 13.0		143.00	
7.0 x 6.0		42.00	
Unit 102/living room			
12.0 x 17.0		204.00	
Unit 102/kitchen			
9.0 x 12.0		108.00	
Unit 103/living room			
1.0 x 10.5		10.50	
1		736.50	
30 Items	(rounded)	2030	