

Building Sketch

Borrower	n/a		
Property Address	2610 N 24th St		
City	Phoenix	County	Maricopa
		State	AZ
		Zip Code	85008
Lender/Client	Gerchick Real Estate		

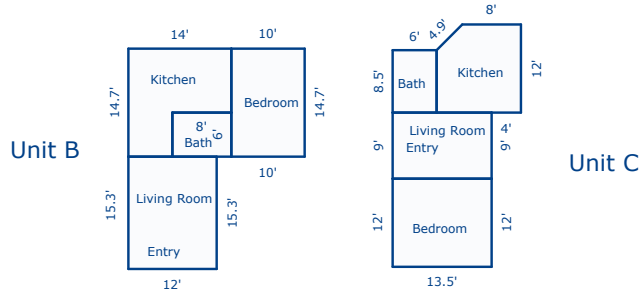

All figures and measurements are approximate.

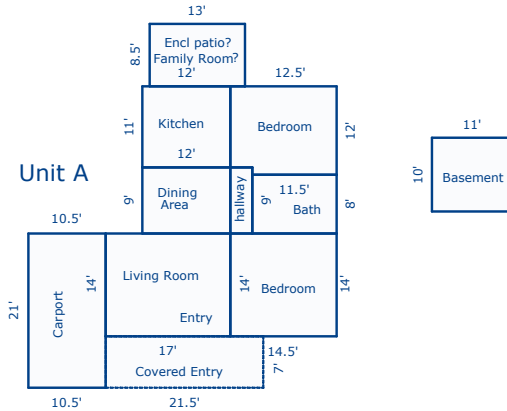

Sketch by Apex Sketch v5 Standard™

Comments:

AREA CALCULATIONS SUMMARY			
Code	Description	Net Size	Net Totals
GLA1	Unit A living room	238.00	
	Unit A dining area	108.00	
	Unit A kitchen	132.00	
	Unit A encl pto/fr	110.50	
	Unit A bedroom 1	171.00	
	Unit A hallway	27.00	
	Unit A bedroom 2	203.00	
	Unit A bathroom	92.00	
	Unit A basement	110.00	
	Unit B living room	183.60	
	Unit B bathroom	48.00	
	Unit B bedroom	147.00	
	Unit B kitchen	157.80	
	Unit C bedroom	162.00	
	Unit C living room	121.50	
Unit C bathroom	51.00		
	Unit C kitchen	131.88	2194.28
GAR	Carport	220.50	220.50
P/P	Covered Entry	150.50	150.50
	Net LIVABLE Area	(rounded)	2194

LIVING AREA BREAKDOWN			
Breakdown		Subtotals	
Unit A living room			238.00
14.0 x	17.0		
Unit A dining area			108.00
9.0 x	12.0		
Unit A kitchen			132.00
11.0 x	12.0		
Unit A encl pto/fr			110.50
8.5 x	13.0		
Unit A bedroom 1			171.00
14.5 x	11.0		
Unit A hallway			27.00
1.0 x	11.5		
Unit A bedroom 2			203.00
14.5 x	14.0		
Unit A bathroom			92.00
8.0 x	11.5		
Unit A basement			110.00
10.0 x	11.0		
Unit B living room			183.60
12.0 x	15.3		
Unit B bathroom			48.00
6.0 x	8.0		
Unit B bedroom			147.00
10.0 x	14.7		
Unit B kitchen			157.80
6.0 x	6.0		
8.7 x	14.0		121.80
6			466.38
21 Items		(rounded)	2194