

## Building Sketch

Borrower	n/a			
Property Address	5714 E Claire Dr			
City	Scottsdale	County Maricopa	State AZ	Zip Code 85254
Lender/Client	Gerchick Real Estate			

All figures and measurements are approximate

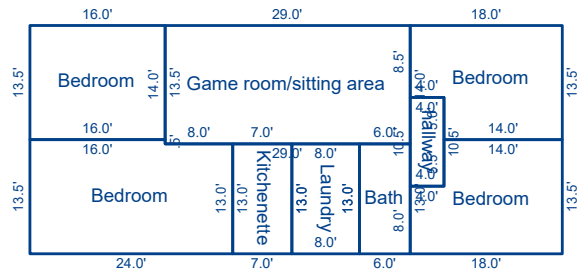
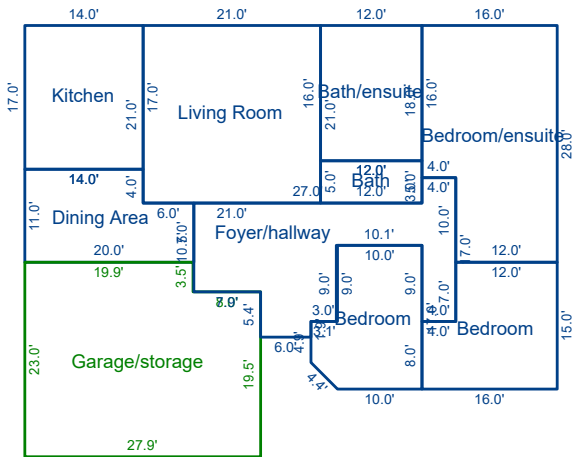

Sketch by ApexSketch

AREA CALCULATIONS SUMMARY						AREA CALCULATIONS BREAKDOWN				
Code	Description	Factor	Net Size	Perimeter	Net Totals	Name	Base x	Height x	Width =	Area
GLA1	Kitchen	1.0	238.0	62.0	2277.9	Kitchen		17.0 x	14.0 =	238.0
	Dining Area	1.0	196.0	62.0		Living Room		21.0 x	21.0 =	441.0
	Bath	1.0	60.0	34.0		Bath/ensuite		16.0 x	12.0 =	192.0
	Bedroom	1.0	191.5	58.4		Bedroom/ensuite		18.0 x	16.0 =	288.0
	Foyer/hallway	1.0	339.4	117.7		Bedroom		15.0 x	12.0 =	180.0
	Bedroom/ensuite	1.0	408.0	88.0		Bedroom		8.0 x	4.0 =	32.0
	Bath/ensuite	1.0	192.0	56.0		Bedroom	0.5 x	4.4 x	2.2 =	4.9
	Living Room	1.0	441.0	84.0		Bedroom		4.9 x	3.1 =	15.3
	Bedroom	1.0	212.0	62.0		Bedroom		9.0 x	0.1 =	1.3
	Bedroom	1.0	320.0	75.0		Bedroom		17.0 x	10.0 =	170.0
GLA2	Bedroom	1.0	216.0	59.0	Bath		12.0 x	5.0 =	60.0	
	Game room/sitti	1.0	406.0	86.0	Dining Area		14.0 x	11.0 =	154.0	
	Bedroom	1.0	223.0	63.0	Bedroom		7.0 x	6.0 =	42.0	
	Bedroom	1.0	221.0	63.0	Foyer/hallway		17.0 x	4.0 =	68.0	
	Bath	1.0	78.0	38.0	15 addl items		15.9 x	6.0 =	94.5	
	Laundry	1.0	104.0	42.0	31 total items			(rounded)	3,979	
	3 addl items									
	Net LIVABLE	cnt	18	(rounded)	3,979					