

Building Sketch

Borrower	n/a			
Property Address	5720 E Claire Dr			
City	Scottsdale	County	Maricopa	State AZ Zip Code 85254
Lender/Client	Gerchick Real Estate			

All figures and measurements are approximate

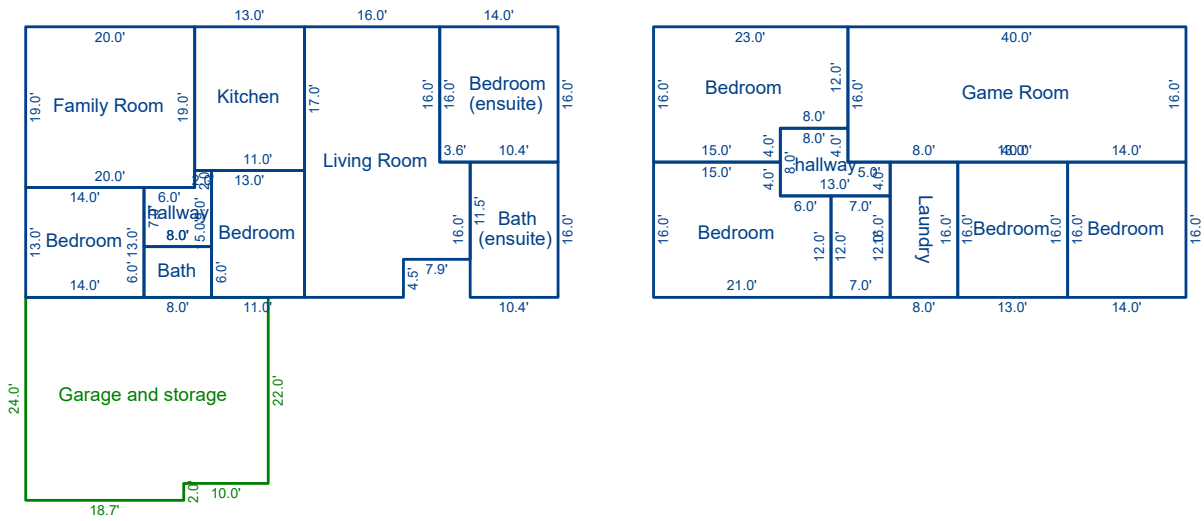

Sketch by ApexSketch

AREA CALCULATIONS SUMMARY						AREA CALCULATIONS BREAKDOWN				
Code	Description	Factor	Net Size	Perimeter	Net Totals	Name	Base x	Height x	Width =	Area
GLA1	Bath	1.0	48.0	28.0	1980.5	Family Room	20.0 x	19.0 =		380.0
	Family Room	1.0	380.0	78.0		Kitchen	17.0 x	13.0 =		221.0
	Kitchen	1.0	221.0	60.0		Bedroom (ensuite)	16.0 x	14.0 =		224.0
	Bedroom (ensuit	1.0	224.0	60.0		Bath (ensuite)	16.0 x	10.4 =		166.4
	Bath (ensuite)	1.0	166.4	52.8		Living Room	32.0 x	3.6 =		115.2
	Living Room	1.0	534.1	103.2			16.0 x	11.5 =		184.0
	Bedroom	1.0	165.0	52.0			8.1 x	4.5 =		36.5
	Bedroom	1.0	182.0	54.0			16.0 x	12.4 =		198.4
	hallway	1.0	60.0	34.0		Bedroom	15.0 x	11.0 =		165.0
	Bedroom	1.0	336.0	78.0		Bedroom	14.0 x	13.0 =		182.0
GLA2	Laundry	1.0	128.0	48.0	Bath	8.0 x	6.0 =		48.0	
	Bedroom	1.0	208.0	58.0	hallway	8.0 x	7.0 =		56.0	
	hallway	1.0	84.0	42.0		2.0 x	2.0 =		4.0	
	Game Room	1.0	640.0	112.0	Game Room	40.0 x	16.0 =		640.0	
	Bedroom	1.0	312.0	74.0	Bedroom	16.0 x	14.0 =		224.0	
	Bedroom	1.0	224.0	60.0	Bedroom	16.0 x	13.0 =		208.0	
	1 addl items				7 addl items					
	Net LIVABLE	cnt	16	(rounded)	3,912	23 total items			(rounded)	3,912