

Building Sketch

Borrower	n/a						
Property Address	9033 N 11th St						
City	Phoenix	County	Maricopa	State	AZ	Zip Code	85020
Lender/Client	Gerchick Real Estate						

All figures and measurements are approximate

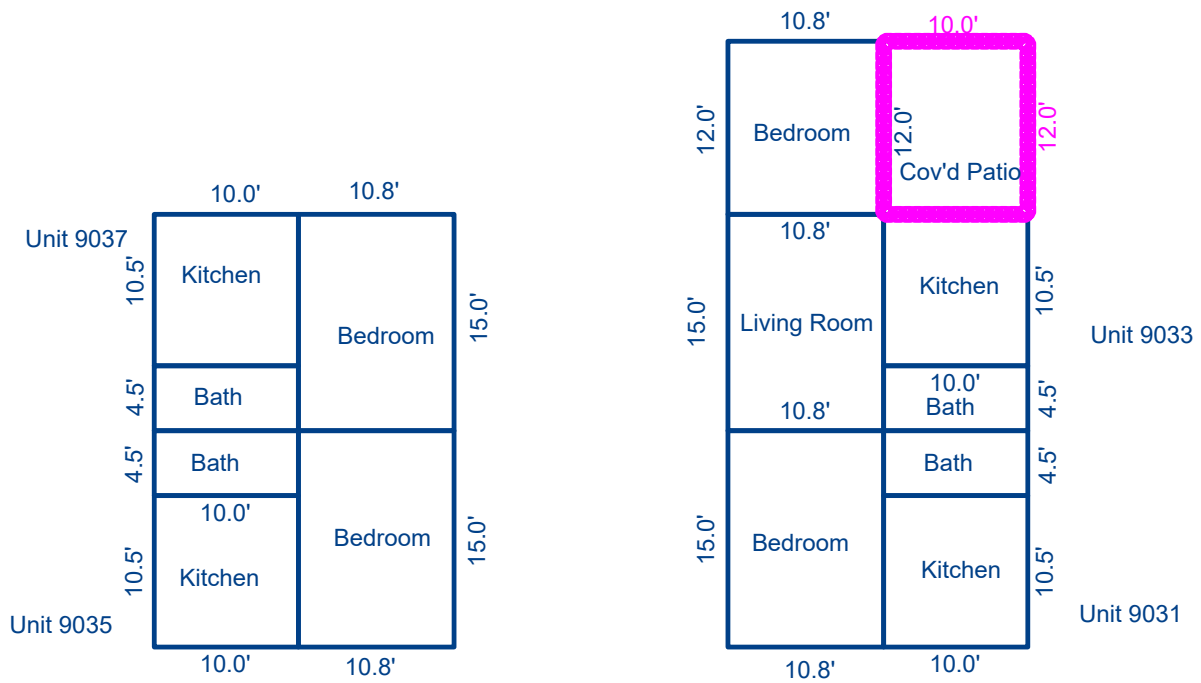

Sketch by ApexSketch

AREA CALCULATIONS SUMMARY						AREA CALCULATIONS BREAKDOWN				
Code	Description	Factor	Net Size	Perimeter	Net Totals	Name	Base x	Height x	Width =	Area
GLA1	Unit 9031 kitche	1.0	105.0	41.0	1377.6	Unit 9031 kitchen	10.5 x	10.0 =	105.0	
	Unit 9031 bath	1.0	45.0	29.0		Unit 9031 bath	10.0 x	4.5 =	45.0	
	Unit 9031 bedro	1.0	162.0	51.6		Unit 9031 bedro	15.0 x	10.8 =	162.0	
	Unit 9033 bathro	1.0	45.0	29.0		Unit 9033 bathro	10.0 x	4.5 =	45.0	
	Unit 9033 kitche	1.0	105.0	41.0		Unit 9033 kitchen	10.5 x	10.0 =	105.0	
	Unit 9033 bedro	1.0	129.6	45.6		Unit 9033 bedro	12.0 x	10.8 =	129.6	
	Unit 9033 living	1.0	162.0	51.6		Unit 9033 living r	15.0 x	10.8 =	162.0	
	Unit 9035 kitche	1.0	105.0	41.0		Unit 9035 kitchen	10.5 x	10.0 =	105.0	
	Unit 9035 bathro	1.0	45.0	29.0		Unit 9035 bathro	10.0 x	4.5 =	45.0	
	Unit 9035 bedro	1.0	162.0	51.6		Unit 9035 bedro	15.0 x	10.8 =	162.0	
	Unit 9037 bedro	1.0	162.0	51.6		Unit 9037 bedro	15.0 x	10.8 =	162.0	
	Unit 9037 kitche	1.0	105.0	41.0		Unit 9037 kitchen	10.5 x	10.0 =	105.0	
	Unit 9037 bathro	1.0	45.0	29.0		Unit 9037 bathro	10.0 x	4.5 =	45.0	
	P/P	Cov'd Patio	1.0	120.0		44.0	120.0			
	Net LIVABLE	cnt	13 (rounded)	1,378	13 total items		(rounded)	1,378		