

Building Sketch

Borrower	n/a						
Property Address	8816 N 6th Pl						
City	Phoenix	County	Maricopa	State	AZ	Zip Code	85020
Lender/Client	Harry F. D'Elia III						

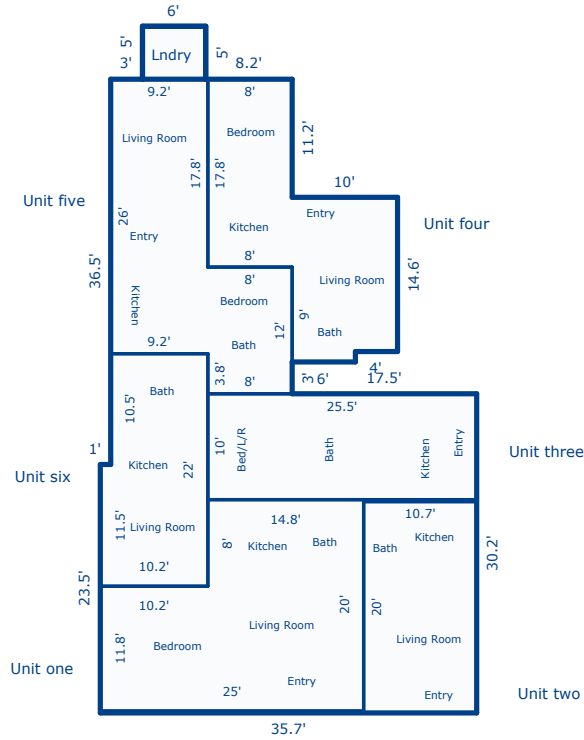

All figures and measurements are approximate.

Sketch by Apex Sketch v5 Standard™

Comments:

AREA CALCULATIONS SUMMARY			
Code	Description	Net Size	Net Totals
GLA1	Unit two	214.00	
	Unit three	255.00	
	Unit four	294.40	
	Unit five	335.20	
	Unit six	213.90	
	Unit one	416.36	1728.86
GBA1	First Floor	1766.00	
	Laundry	-30.00	1736.00
	Net LIVABLE Area	(rounded)	1729
	Net BUILDING Area	(rounded)	1736

LIVING/BUILDING AREA BREAKDOWN			
Breakdown			Subtotals
Unit two	20.0 x	10.7	214.00
Unit three	25.5 x	10.0	255.00
Unit four	18.0 x	6.6	118.80
	11.2 x	8.0	89.60
	8.0 x	10.0	80.00
	1.0 x	6.0	6.00
Unit five	17.8 x	9.2	163.76
	3.8 x	8.0	30.40
	8.2 x	17.2	141.04
Unit six	10.5 x	9.2	96.60
	11.5 x	10.2	117.30
Unit one	14.8 x	8.2	121.36
	11.8 x	25.0	295.00
First Floor	23.5 x	35.7	838.95
	6.7 x	34.7	232.49
	5.0 x	6.0	30.00
	11.2 x	17.2	192.64
	14.6 x	27.2	397.12
	1.0 x	23.2	23.20
	3.0 x	17.2	51.60
Laundry	6.0 x	5.0	-30.00
21 Items		(rounded)	3465