

## Building Sketch

Borrower	n/a						
Property Address	5112 N 28th Dr						
City	Phoenix	County	Maricopa	State	AZ	Zip Code	85017
Lender/Client	Gerchick Real Estate						

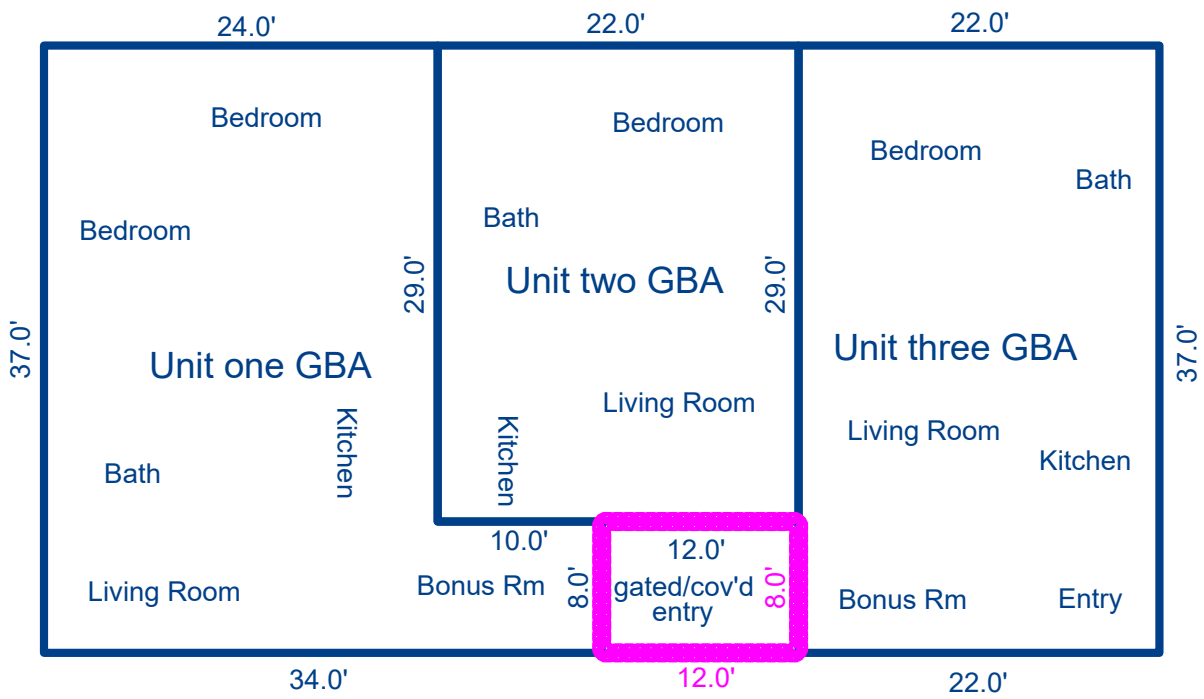

Sketch by ApexSketch

AREA CALCULATIONS SUMMARY						AREA CALCULATIONS BREAKDOWN				
Code	Description	Factor	Net Size	Perimeter	Net Totals	Name	Base x	Height x	Width =	Area
GBA1	Unit one GBA	1.0	968.0	142.0	2420.0	Unit one GBA	37.0 x	24.0 =	888.0	
	Unit two GBA	1.0	638.0	102.0		Unit two GBA	10.0 x	8.0 =	80.0	
	Unit three GBA	1.0	814.0	118.0		Unit three GBA	29.0 x	22.0 =	638.0	
P/P	Gated/cov'd entr	1.0	96.0	40.0	96.0		37.0 x	22.0 =	814.0	
	Net BUILDING	cnt	3 (rounded)		2,420	4 total items		(rounded)		2,420

© ILOOKABOUT (US) Inc. dba Apex Software