

**DEMOLITION NOTES**

1. THE CONTRACTOR SHALL VERIFY THE EXISTENCE OF BID AND REPORT ANY CONDITIONS WHICH MAY CAUSE CONSTRUCTION PROBLEMS. ANY VARIANCES OR WORK NOT INDICATED ON THE DRAWINGS BUT REQUIRED TO COMPLETE THE PROJECT SHALL BE REPORTED TO THE ARCHITECT PRIOR TO COMMENCEMENT OF CONSTRUCTION.
2. ALL SALVAGEABLE EQUIPMENT SHALL BECOME THE PROPERTY OF THE CONTRACTOR FOR HIS DISPOSAL EXCEPT AS NOTED. ALL DEBRIS AND MATERIAL TO BE ABANDONED SHALL BE DISPOSED OF BY THE CONTRACTOR.
3. DEMOLITION WORK TO BE COMPLETE WITH AS LITTLE DISRUPTION TO OTHER AREAS AS POSSIBLE. CONTRACTOR TO REMOVE DEBRIS FROM IT COLLECTING WITHIN THE PREMISES.
4. FRONT ENTRANCE DEMOLITION TO BE AS REQUIRED TO ACCOMMODATE NEW CONSTRUCTION. SEE DRAWINGS AND COORDINATE IN FIELD.
5. INTERIOR DEMOLITION TO INCLUDE ALL EXISTING MATERIALS AS REQUIRED TO ACCOMMODATE NEW CONSTRUCTION. PATCH AND PREP ADJACENT SURFACES TO REMAIN AND FINISH TO MATCH AS REQUIRED.
6. THE CONTRACTOR SHALL PROVIDE A BARRICADE. IN ADDITION, PROVIDE ANY SAFETY OR PARKING DEVICES AS REQUIRED TO PROTECT THE PUBLIC FROM ANY DANGEROUS AREAS.
7. PROVIDE DUMPSTER OR OTHER TRASH DEVICE COORDINATE WITH LANDLORD FOR LOCATION. CLEAN UP ALL DEBRIS OR DIRT WHICH MAY OCCUR PRIOR TO OPERATION. FAILURE TO DO SO WILL RESULT IN OTHER PERIODS STOPPING THIS AS CONTRACTOR'S RESPONSIBILITY. PROTECT ALL AREAS NOT UNDERGOING ALTERATION, ADJOINING SPACES, AND PUBLIC AREAS FROM ANY DAMAGE WHICH MAY ARISE FROM THE WORK.
8. DEMOLITION AND NEW WORK SHALL TAKE PLACE IN ACCORDANCE WITH ALL REGULATIONS AND GUIDELINES, INCLUDING ANY WORK WHICH MAY TAKE PLACE OR BE DIRECTED TO TAKE PLACE OVERNIGHT. THE COST FOR WHICH SHALL BE INCLUDED IN THE BASE BID. VERIFY WITH LANDLORD'S REP FOR REQUIREMENTS.
9. REFER TO ELECTRICAL AND MECHANICAL PLANS FOR ADDITIONAL DEMOLITION REQUIREMENT.
10. RELOCATE INTERIOR DOORS AS NOTED ON THE DOOR SCHEDULE.

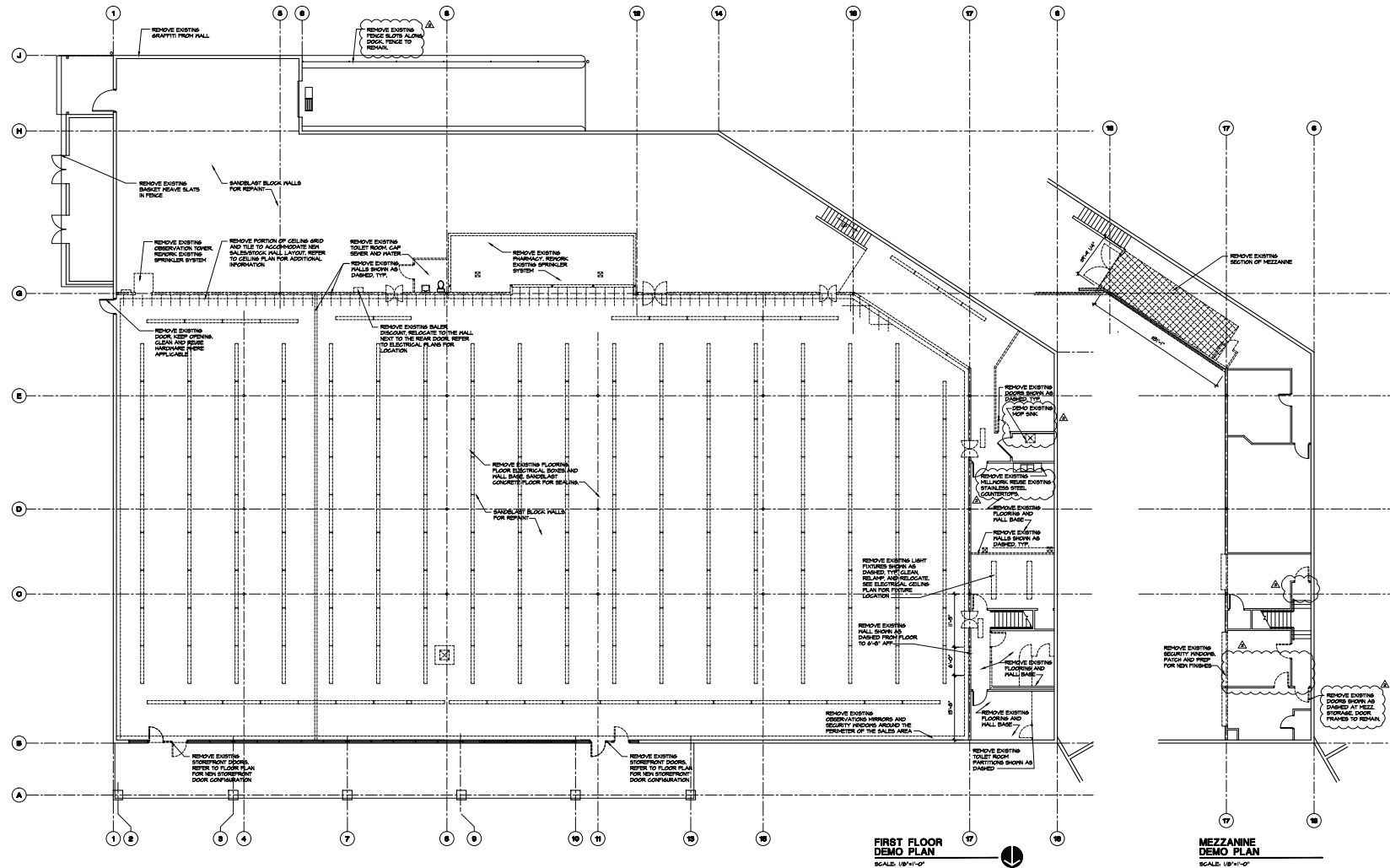

**FIRST FLOOR DEMO PLAN**  
SCALE: 1/8"=1'-0"

**MEZZANINE DEMO PLAN**  
SCALE: 1/8"=1'-0"

DESIGN AND CONSTRUCTION SERVICES  
10000 N. CENTRAL AVENUE, SUITE 200  
TUCSON, AZ 85704  
TEL: (520) 298-1000  
WWW.HERSCHMANARCHITECTS.COM

Date	Issue
10/8/07	TERRACE REVISION
11/28/07	TERRACE REVISION
11/28/07	FIRST FLOOR REVISION
12/18/07	MEZZANINE CITY COMMENTS

Drawn By: JALB  
Project No.: 11102.00

HERSCHMAN ARCHITECTS  
10000 N. CENTRAL AVENUE, SUITE 200  
TUCSON, AZ 85704  
TEL: (520) 298-1000  
WWW.HERSCHMANARCHITECTS.COM

HERSCHMAN ARCHITECTS  
10000 N. CENTRAL AVENUE, SUITE 200  
TUCSON, AZ 85704  
TEL: (520) 298-1000  
WWW.HERSCHMANARCHITECTS.COM