

Building Sketch

Borrower	n/a			
Property Address	715 W Cinnabar Ave			
City	Phoenix	County	Maricopa	State AZ Zip Code 85021
Lender/Client	Gerchick Real Estate			



All figures and measurements are approximate

715 W Cinnabar Ave (units 1-6)

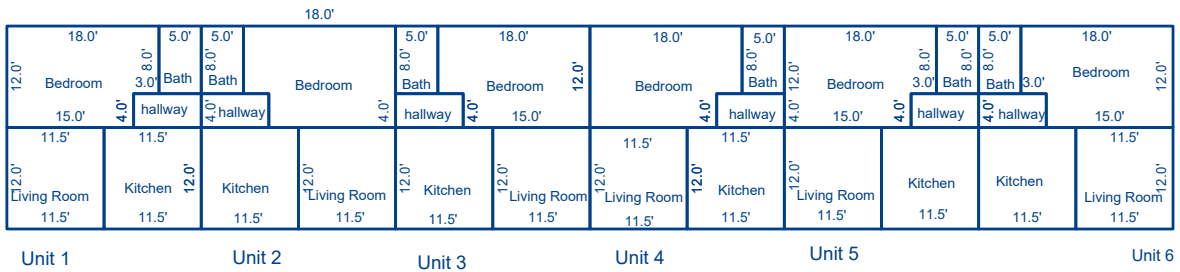

Sketch by ApexSketch

AREA CALCULATIONS SUMMARY						AREA CALCULATIONS BREAKDOWN				
Code	Description	Factor	Net Size	Perimeter	Net Totals	Name	Base x	Height x	Width =	Area
GLA1	Unit six living ro	1.0	138.0	47.0		Unit six living roo	12.0 x	11.5 =		138.0
	Unit one living ro	1.0	138.0	47.0		Unit six bedrom	15.0 x	12.0 =		180.0
	Unit one bedroo	1.0	204.0	60.0			8.0 x	3.0 =		24.0
	Unit one bathroo	1.0	40.0	26.0		Unit six bathroom	8.0 x	5.0 =		40.0
	Unit two hallway	1.0	32.0	24.0		Unit six kitchen	12.0 x	11.5 =		138.0
	Unit two bathroo	1.0	40.0	26.0		Unit six hallway	8.0 x	4.0 =		32.0
	Unit two bedroo	1.0	204.0	60.0		Unit five bathroo	8.0 x	5.0 =		40.0
	Unit two kitchen	1.0	138.0	47.0		Unit five bedroom	18.0 x	8.0 =		144.0
	Unit two living ro	1.0	138.0	47.0			15.0 x	4.0 =		60.0
	Unit three bathro	1.0	40.0	26.0		Unit five hallway	8.0 x	4.0 =		32.0
	Unit three hallwa	1.0	32.0	24.0		Unit five kitchen	12.0 x	11.5 =		138.0
	Unit three bedro	1.0	204.0	60.0		Unit five living ro	12.0 x	11.5 =		138.0
	Unit three kitche	1.0	138.0	47.0		Unit four kitchen	12.0 x	11.5 =		138.0
	Unit three living	1.0	138.1	47.0		Unit four living ro	12.0 x	11.5 =		138.0
Unit four hallway	1.0	32.0	24.0	Unit four bedroo	15.0 x	12.0 =		180.0		
Unit four bathroo	1.0	40.0	26.0		8.0 x	3.0 =		24.0		
14 addl items					21 addl items					
Net LIVABLE	cnt	30	(rounded)	3,312	37 total items			(rounded)	3,312	